



## GOCYCLE SERVICE NOTICE 8.0

X	<b>HIGHLY RECOMMENDED</b>	WITHOUT SERVICE ACTION, COMPONENT DAMAGE CAN OCCUR
---	---------------------------	--



### *Battery Installation*

---

#### Service Issue

Frame numbers affected: All

Installing the battery pack for the first time can be challenging due to the internal cables in the frame being in a 'relaxed' state. Forcing the battery pack into the frame without first pulling the cables tight could damage the battery pack.

---

#### Corrective Action

8.1 Access the battery aperture in the frame as shown.

See <http://www.youtube.com/watch?v=iYTQwDwGjSA>



Battery aperture in frame. Look inside to see if the cables are 'relaxed' as show in step 8.2.



8.2 Look inside the battery aperture in the frame.

The picture below shows the cables in a 'relaxed' state making it very difficult to install the battery pack.



Cables can be 'relaxed' and bunched up, which can make it hard to insert the battery pack.

8.3 Pull the cables about 80-100mm in the direction shown.



Pull the cables this way about 80-100mm to tighten them inside the frame.



8.4 Notice how the cables are now tightened inside the frame.

This will allow the battery to be installed easily.



This shows the cables now 'tightened' and out of the way of the battery pack.

8.5 Remove this rubber tube from the battery thumb screw before installing the battery pack.

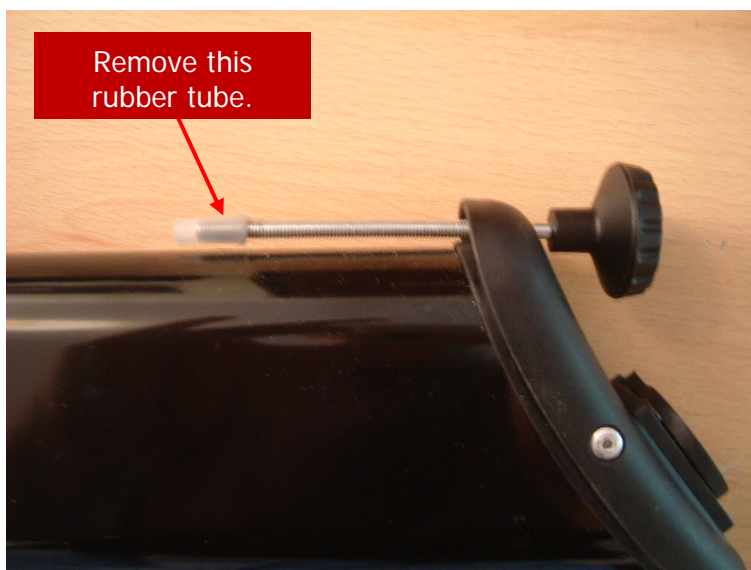

**WARNING!** Do not force the battery pack into the frame. If it does not go in easily, the cables inside the frame should be pulled tight.